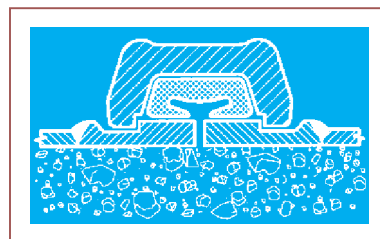

**PAMEC**

Concrete pumping & placing systems

PAMEC S.r.l.Z.I. Punta Penna - 66054 - VASTO (CH) - Italy
Tel. +39-0873-310000 - Fax: +39 - 0873 - 311787
http://www.pamec.com - E-mail: info@pamec.com

GIUNTI COUPLINGS

**in acciaio stampato a caldo**
*in drop forged steel***SISTEMA "GU"**
"GU" SYSTEM (Metric)

GF

Giunto fisso a leva
Non adjustable snap coupling

D.N.		TIPO - TYPE	CODICE CODE No.	KG	LBS	
in.	mm					
3.1/4"	80/97.0	GF 34 M	02 34 1 001 00	2.40	5.29	
4"	100/114.3	GF 40 M	02 40 1 001 50	3.50	7.71	
4.1/2"	100/127.0	GF 45 M	02 45 1 001 50	4.65	10.25	
5"	125/141.3	GF 50 M	02 50 1 001 50	5.00	11.03	
5.1/2"	125/148.0	GF 55 M	02 55 1 001 50	5.50	12.12	
6"	150/168.3	GF 60 M	02 60 1 001 00	5.50	12.12	
7"	180/200.0	GF 70 M	02 70 1 001 00	5.90	13.00	

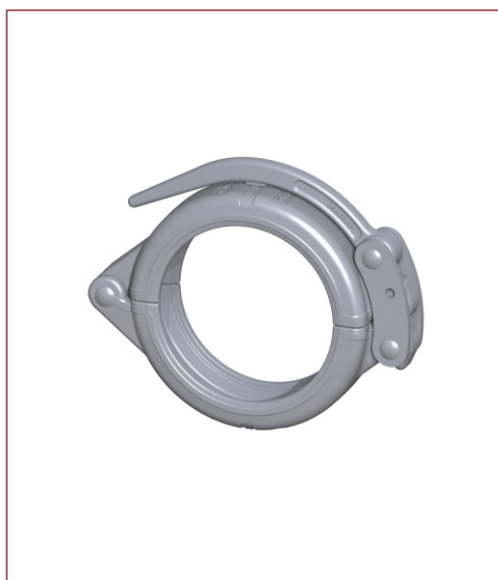

GF - LC

Giunto fisso a leva corta
Non adjustable snap coupling - short lever

D.N.		TIPO - TYPE	CODICE CODE No.	KG	LBS	
in.	mm					
4"	100/114.3	GF 40 M - LC	02 40 1 001 60	3.47	7.65	
4.1/2"	100/127.0	GF 45 M - LC	02 45 1 001 60	4.61	10.16	
5"	125/141.3	GF 50 M - LC	02 50 1 001 60	4.96	10.93	
5.1/2"	125/148.0	GF 55 M - LC	02 55 1 001 60	5.45	12.01	

□ Tutti i giunti possono essere zincati - *All couplings can be galvanized.***CONCRETE PUMPING SYSTEMS****B M 20 00**